

# ICE BEAR ALARM

## 12g Tripwire Intruder Warning

### SAFETY FIRST

This device has been designed for heavy duty professional use. Treat it with respect. Failure to follow operating instructions could result in serious injury. It has not been designed to inflict injury of any kind - it is to be used only to warn of the presence of an intruder. It has been designed to use Black Powder blank cartridges. Never, ever use cartridges which still contain shot or pellets, as this could result in very serious injury.

Keep children and pets away from the device. Never use the alarm indoors or near any kind of flammable material as it could create a potential fire risk. Always wear eye protection when arming or disarming the device. It is not to be used by anyone under 18 years of age. Arctic Limited does not accept any responsibility or liability for injury or damage however caused.

### INSTRUCTIONS FOR USE

Fix the alarm in an upright position, using either screws, nails, wire, string (through the holes in the body), tape or a cable-tie. The notch around the middle of the body is used when securing the alarm with a cable-tie (e.g. if you are attaching to a pole). I prefer to use 50mm reinforced gaffer, or duct tape to attach the alarm.

In extremely cold conditions it is possible to use a little low temperature lubricant inside the spring chamber to reduce the risk of freezing. Vehicle lock de-icer and lubricant is ideal for this.

### MAINTENANCE

The alarm requires no maintenance other than keeping it clean. Dirt and grit should be kept away from moving parts by rinsing or flushing with clean water.

The body is machined from a block of aluminium. The safety pin and 'R' clip are made from galvanised carbon steel. All other parts, including the sear and sear ring are made of stainless steel and are highly rust resistant.

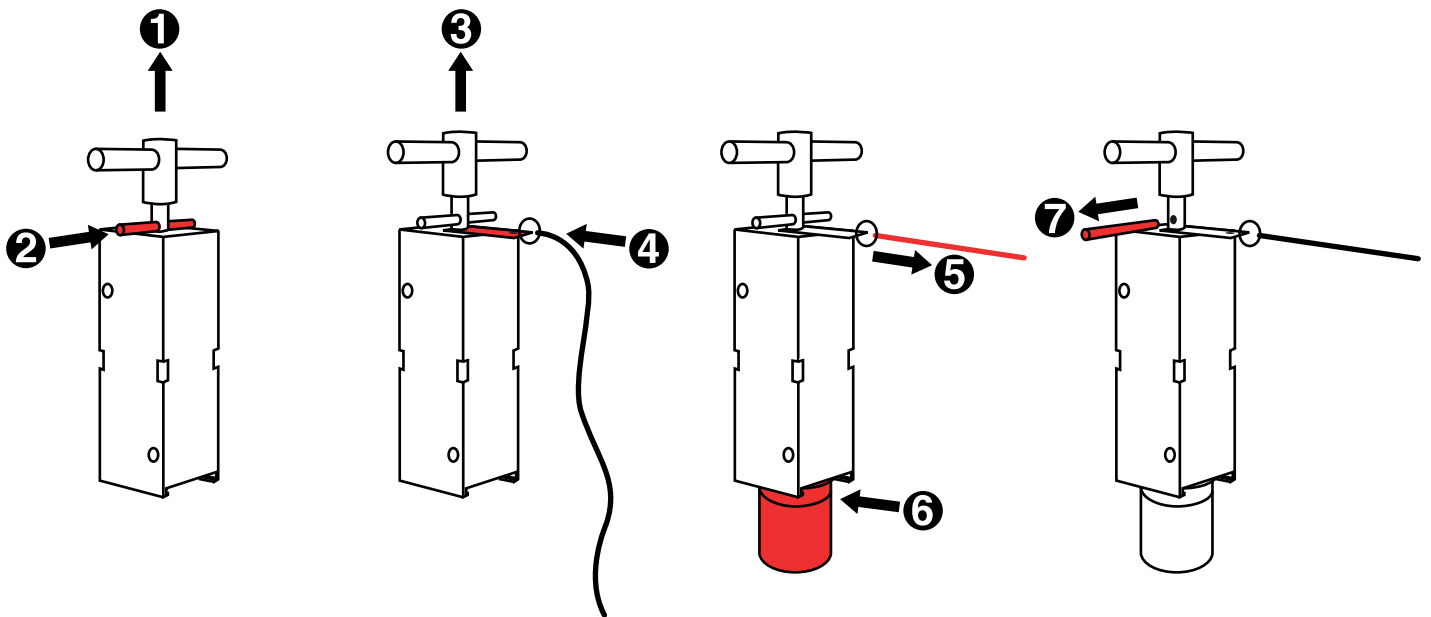

1. Pull up the firing pin until you can see the hole for inserting the safety device.

*The firing pin will also need to be pulled up slightly to release a spent cartridge.*

2. Insert the safety device. Use a lockable safety pin (supplied) as it can't be accidentally removed.

*With the safety pin securely in place the device will not fire.*

3. Pull up the firing pin a little more.

4. When the groove in the shaft appears, insert the release sear into it.

*By experimenting with how far the release sear is inserted, you can choose how much force is required before the alarm detonates. Practice without wasting blank cartridges.*

*It is important that you attach the tripwire to the release sear ring with a non-slipping knot. For example see overleaf.*

5. Stretch the tripwire from the alarm to another firm object and tie-off. Use non-stretch fishing line and a non-slipping knot.

6. FULLY insert a blank cartridge.

*NEVER insert or remove a live cartridge without setting the safety device (2) first.*

*NEVER use cartridges which still contain shot or pellets - this obviously could cause very serious injury if fired.*

7. Gently remove the safety device.

*WARNING! The apparatus is now armed and will fire when the sear is pulled away from the device by movement on the line.*

*WARNING! It is vital that the cartridge doesn't move out of the firing position as this could result in a mis-fire. If it is windy or the device is likely to be knocked, use the 'R' clip (supplied) to hold the cartridge in position. See overleaf.*

*Arctic Limited does not accept any responsibility for injury or damage however caused.*

